

# Slippery Elm Hollow Plat 4

Another Quality Development by Rick Metz

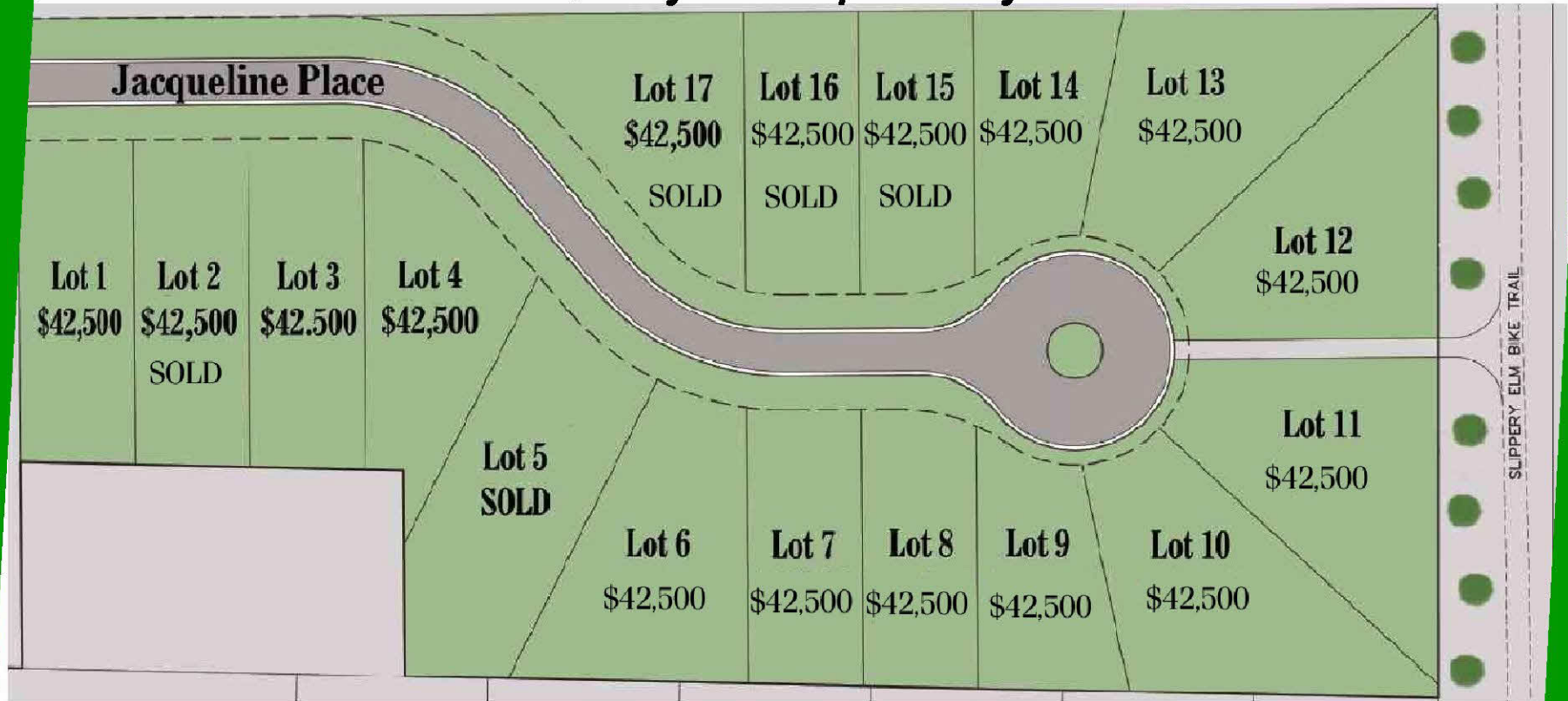

- **12 Lots Available**
- **\$42,500 each**
- **BG Municipal Utilities**



**A.A. GREEN**  
REALTY, INC.

TIM WESTHOVEN, REALTOR®  
**WESTHOVEN**

*Building dreams on higher ground.*

419-409-1000 mo-

